

**DELTA<sup>®</sup> System**

DELTA<sup>®</sup> protects property. Saves energy. Creates comfort.

**DELTA<sup>®</sup>**

**Premium Moisture Management  
Systems for Foundations.**

**COSELLA DÖRKEN**



DELTA<sup>®</sup> Premium Moisture Management Systems provide the best protection for foundations.

Continuity is critical to effectively keeping moisture out of basements. A Systems approach to foundation protection will block water, both as liquid and as vapor, at all possible points of entry.

Applying DELTA<sup>®</sup>-THENE and DELTA<sup>®</sup>-DRAIN to the vertical foundation wall is an excellent combination for waterproofing and drainage. DELTA<sup>®</sup>-COLDJOINT BARRIER provides additional security at the crucial foundation wall/footing junction. To prevent moisture movement into the basement due to the capillary rise of water through the footing, install DELTA<sup>®</sup>-FOOTING BARRIER when the footings are poured. The final gateway for moisture is the floor slab. DELTA<sup>®</sup>-MS UNDERSLAB will not only act as waterproofing, it will also be the vapor barrier.

Homeowners will appreciate the value of basement living space their family can grow into.

DELTA<sup>®</sup> Premium Moisture Management Systems ensure a dry and healthy basement environment.



## INDEX

<b>DELTA®-MS</b> .....	4
The Foundation Wrap.™	
<b>DELTA®-DRAIN</b> .....	5
The Direct Route For Re-Directing Ground Water.™	
<b>DELTA®-FOOTING BARRIER</b> .....	6
Capillary Break Membranes For Footings.™	
<b>DELTA®-MS UNDERSLAB</b> .....	7
Underslab Vapor Retarder.™	
<b>DELTA®-MS Premium Moisture Management System For Foundations</b> .....	8
<b>DELTA®-DRAIN Premium Moisture Management System For Foundations</b> .....	9
<b>DELTA®-COLDJOINT BARRIER</b> .....	10
Below Grade Cold Joint Moisture Protection.™	
<b>DELTA®-THENE</b> .....	10
Self-Adhering Waterproof Membrane.™	
<b>DELTA®-MS CLEAR</b> .....	11
Foundation Wrap For Insulated Concrete Forms.™	
<b>DELTA®-FL</b> .....	12
Keeping Floors Warm & Dry.™	
<b>DELTA® ACCESSORIES</b> .....	13
<b>DELTA® SUSTAINABLE SCIENCE</b> .....	14





ICC-ESR #2303  
CCMC # 12788  
CCMC # 12658

## DELTA<sup>®</sup>-MS The Foundation Wrap.™

DELTA<sup>®</sup>-MS is an outstanding high-performance, below grade foundation protection for masonry and poured concrete structures.

### DELTA<sup>®</sup>-MS ...

- ... large roll sizes allow for easier, quicker installations.
- ... creates a full capillary break.
- ... enhances/ protects dampproofing.
- ... protects foundation from ground water.
- ... environmentally friendly, recyclable.
- ... contains 100% recycled core protected on both sides with virgin HDPE for superior durability.



# DELTA®-DRAIN

## The Direct Route For Re-Redirecting Ground Water.™

DELTA®-DRAIN is an outstanding high-performance, below grade foundation drainage membrane for masonry and poured concrete structures.

### DELTA®-DRAIN ...

- ... large roll sizes allow for easier, quicker installations.
- ... high flow capacity for effective drainage.
- ... enhances/ protects waterproofing.
- ... relieves hydrostatic pressure against foundation walls.
- ... environmentally friendly, recyclable.
- ... contains 100% recycled core protected on both sides with virgin HDPE for superior durability.



CCMC # 13209



## DELTA®-FOOTING BARRIER

**Capillary Break Membrane For Footings.™**

DELTA®-FOOTING BARRIER is a simple solution to the problem of capillary wicking between footings and foundation walls.

### DELTA®-FOOTING BARRIER ...

- ... installs easily between footing and basement wall.
- ... prevents capillary wicking and rising dampness.
- ... helps reduce dampness in basements.
- ... helps to prevent mold.
- ... is ideal for fully insulated basements.



# DELTA®-MS UNDERSLAB

## Underslab Vapor Retarder.™

DELTA®-MS UNDERSLAB is an ideal vapor barrier and sub-base course below concrete slabs.

### DELTA®-MS ...

- ... large roll sizes allow for easier, quicker installations.
- ... protects from ground water.
- ... environmentally friendly, recyclable.
- ... contains 100% recycled core protected on both sides with virgin HDPE for superior durability.
- ... tough and strong to resist job-site traffic.
- ... high compressive strength.

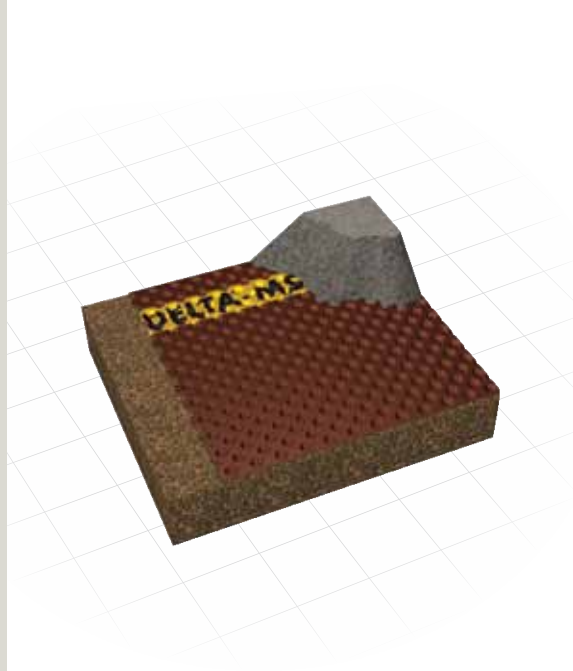

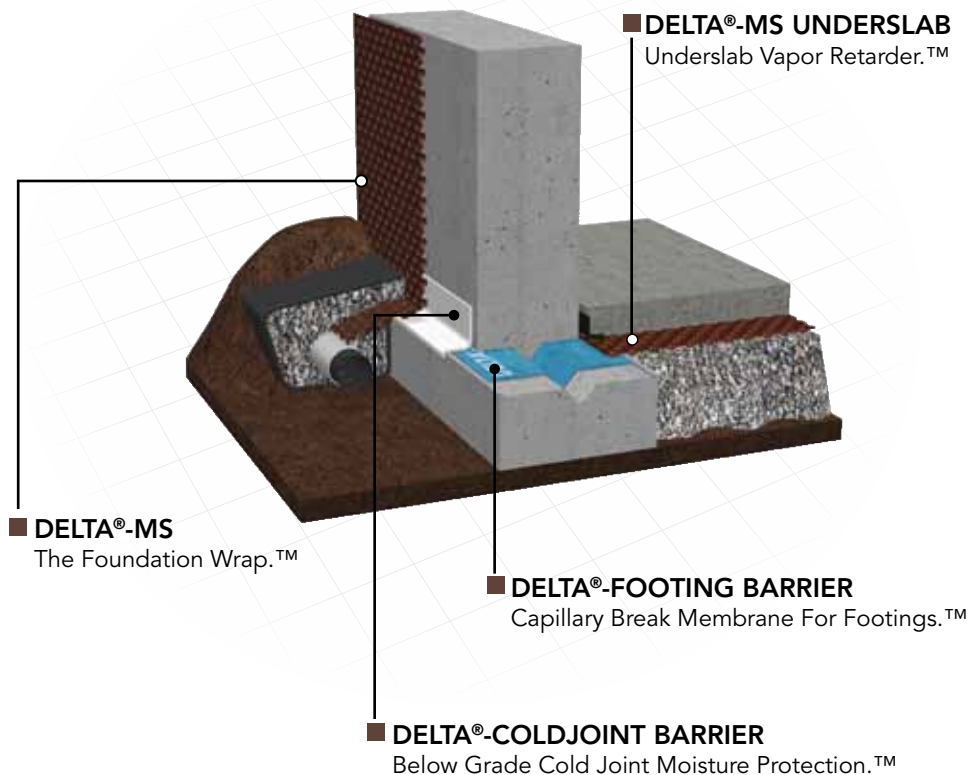

## **DELTA®-MS Premium Moisture Management System For Foundations.**

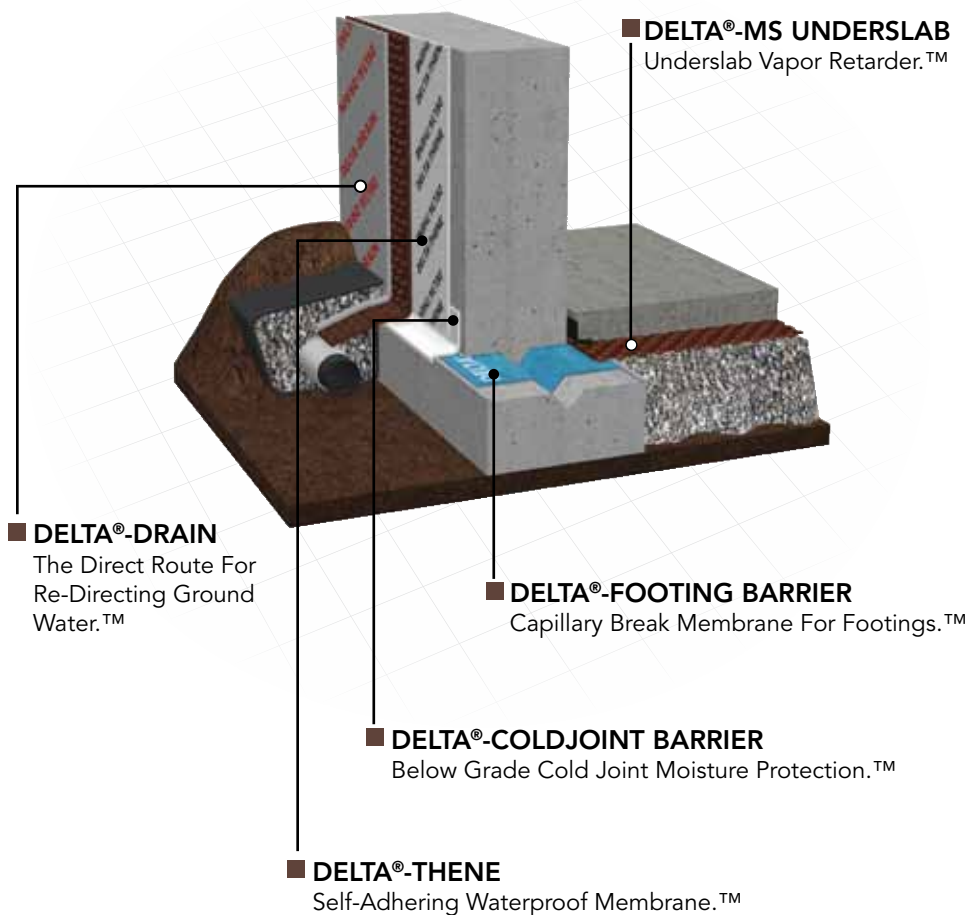

## **DELTA®-DRAIN Premium Moisture Management System For Foundations.**



## DELTA®-COLDJOINT BARRIER

**Below Grade Cold Joint Moisture Protection.™**

DELTA®-COLDJOINT BARRIER waterproofs the critical cold joint between the footing and the foundation wall.

### DELTA®-COLDJOINT BARRIER ...

- ... comes in ideally sized 18" widths.
- ... protects any non-moving cold joints.
- ... enhances/ protects waterproofing.
- ... provides extra security against occasional fluctuating high water tables.
- ... convenient split release for easy application.

## DELTA®-THENE 40 & 60

**Self-Adhering Waterproof Membrane.™**

DELTA®-THENE 40 & 60 are self-adhering waterproofing membranes for below-grade residential and commercial applications.

### DELTA®-THENE 40 & 60 ...

- ... are quickly and safely applied.
- ... provide effective water proof protection.
- ... when used with DELTA® brand drainage composites are part of the DELTA® Premium Moisture Management System.

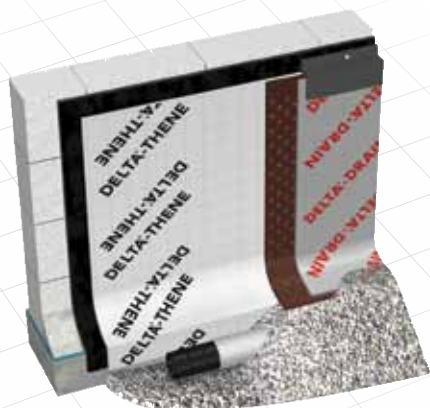

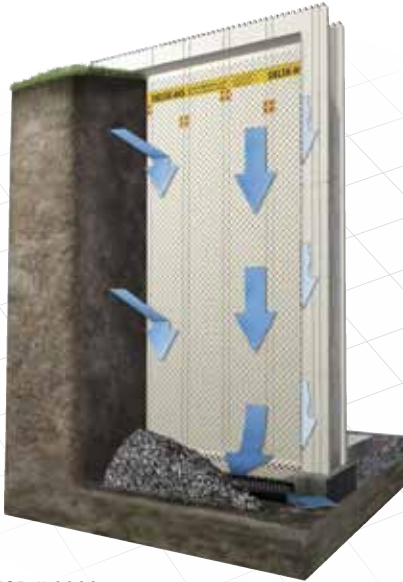

ICC-ESR # 2303

## DELTA®-MS CLEAR

**The Foundation Wrap For Insulated Concrete Forms.™**

DELTA®-MS CLEAR is an outstanding, high performance, below grade foundation protection for I.C.F.

### DELTA®-MS CLEAR ...

- ... is translucent for easy identification of fastening points.
- ... is simple and fast to install.
- ... is an air-gap and drainage membrane all in one.
- ... is unaffected by freeze thaw cycles.
- ... spans and bridges all seams in surfaces.
- ... is non-polluting and non-toxic.
- ... forms an independent skin around the basement for trouble free basements.



## DELTA®-FL

### Keeping Floors Warm & Dry.™

DELTA®-FL is the perfect plastic subfloor system for installed concrete and slab on grade floors.

#### DELTA®-FL ...

- ... fast and easy to install.
- ... no recycled plastic odors.
- ... non-allergenic.
- ... creates a sealed vapor barrier subfloor\* that prevents moisture rise and makes basements feel warm and dry.
- ... laminates can be installed directly on DELTA®-FL.
- ... unlike other subfloor systems, DELTA®-FL will never rot.

\*seams are sealed with DELTA®-MOISTURE PROOF TAPE.

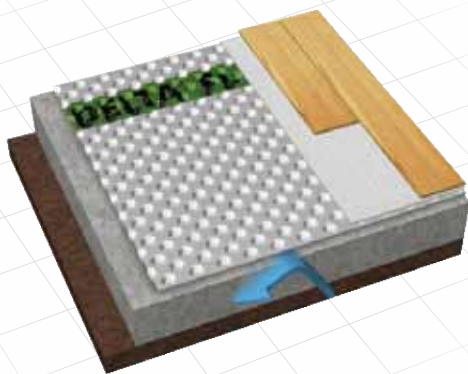

NO ODORS.

NON-ALLERGENIC.

NO OPEN SEAMS





## **DELTA® ACCESSORIES**

### **DELTA®-MOLD STRIP**

DELTA®-MOLD STRIP is a 3" wide molding used to finish off the installation of the DELTA® membrane around windows, doors, or gradient changes in the foundation.

### **DELTA®-FAST'ner™**

DELTA®-FAST'ner™ is a multi-stud fastener for attaching the DELTA®-MS and DELTA®-DRAIN to the foundation walls.

### **DELTA®-FLASH**

DELTA®-FLASH is a 1" wide angle flashing that is used to finish off the top of the flat tab, around windows, and vertical terminations of the DELTA® membrane installations.

### **DELTA®-TERMINATION BAR**

DELTA®-TERMINATION BAR is a strip used to fasten the flat tab of the DELTA® membrane to the foundation walls, and to stop debris from clogging the "air gap" drainage plane behind the membrane.

### **DELTA®-PLUG**

DELTA®-PLUG is a single fastener for attaching DELTA® membranes to foundation walls.

### **DELTA®-SEALANT**

DELTA®-SEALANT is a black mastic formulation used to seal off the flat tab and overlaps in the membranes during installation. It is also used to seal off any gaps in the membrane at interior and exterior corner installations where a tight fit may not be possible, and to seal off gaps around DELTA®-FLASH, DELTA®-TERMINATION BAR or DELTA®-MOLD STRIP.

### **DELTA®-MOISTURE PROOF TAPE**

DELTA®-MOISTURE PROOF TAPE is a polypropylene based sealing product that is extremely resilient to damage. It's very low vapor permeance value makes it an excellent vapor retarder. It also has a very aggressive adhesive that sticks to most materials that are sound, clean and dry. It is used for seaming DELTA®-FL.

### **DELTA®-THENE PRIMER**

DELTA®-THENE PRIMER For Self-adhered Membanes. Water based environmentally friendly formulation. High tack and rubberized. Quick drying.

### **DELTA®-THENE ADHESIVE**

DELTA®-THENE ADHESIVE For Self-adhered Membanes. Quick setting. Aggressive tack provides superior bond for membranes. Normal and low temperature applications.

# DELTA® SUSTAINABLE SCIENCE

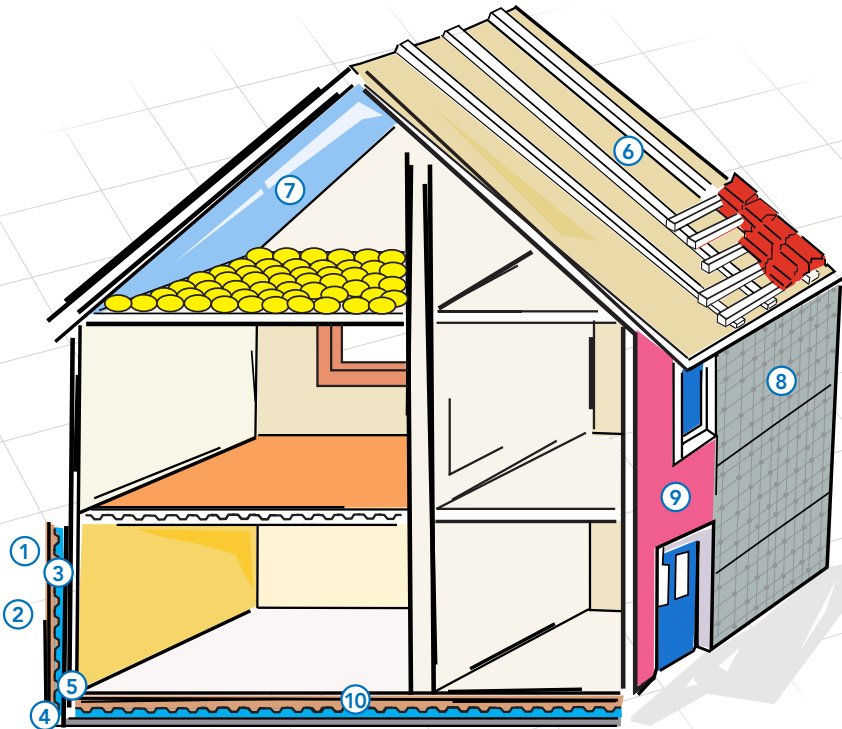

- 1 DELTA®-MS**  
The Foundation Wrap.™
- 2 DELTA®-DRAIN**  
The Direct Route For Re-Redirecting Ground Water.™
- 3 DELTA®-THENE**  
Self Adhering Waterproof Membrane.™
- 4 DELTA®-COLDJOINT BARRIER**  
Below Grade Cold Joint Moisture Protection.™
- 5 DELTA®-FOOTING BARRIER**  
Capillary Break Membrane For Footings.™
- 6 DELTA® ROOF UNDERLAYMENTS**  
New Ideas For Better Roofs.™
- 7 DELTA®-REFLEX**  
Vapor & Air Barrier.
- 8 DELTA®-DRY/ DELTA®-DRY STUCCO & STONE**  
Ventilated Rainscreen For Absorptive Cladding.™
- 9 DELTA® WATER-RESISTIVE BARRIERS**
- 10 DELTA®-MS UNDERSLAB**  
Underslab Vapor Retarder.™

Technical Data Sheets?  
Installation Instructions?  
Guide Specifications?  
Architectural Details?  
Material Safety Data Sheet?

They are available and up-to-date online at [www.cosella-dorken.com](http://www.cosella-dorken.com)



Our DELTA®-MS & DELTA®-DRAIN products are manufactured using an exclusive three-layer co-extrusion process. The central core contains 100% post-industrial and post-consumer recycled material that captures and reuses material reclaimed from household Blue Boxes. The two outer layers that encase the recycled core are virgin polyethylene that ensures the sustainability and long life of our DELTA®-MS & DELTA®-DRAIN products for years after installation. By applying the dual principles of recycling and sustainability, Cosella-Dörken Products, Inc. is demonstrating a long term commitment to the environment.

Printed in Canada 10/11 v4 2m

# DELTA®

DELTA® is a registered trademark of Ewald Dörken AG, Herdecke, Germany

**COSELLA DÖRKEN**

Cosella-Dörken Products Inc.  
4655 Delta Way  
Beamsville, Ontario  
L0R 1B4  
(905) 563-3255  
Fax: (905) 563-5582  
1-888-4DELTA4(433-5824)  
info@cosella-dorken.com  
www.cosella-dorken.com

A company of the Dörken Group

The information printed in this brochure reflects product information and specifications at the date of printing. The manufacturer reserves the right to make changes when necessary.



**Canadian**  
Home Builders'  
Association



Member  
**NAHB**  
NATIONAL ASSOCIATION  
OF HOME BUILDERS

DELTA®-branded quality products manufactured by Cosella-Dörken.